

**Use:**

- For the prevention of pregnancy.
- With a diaphragm, condom or alone.

**Precautions:** An association has been reported between diaphragm use and toxic shock syndrome (TSS), a serious condition which can be fatal. For contraceptive effectiveness, the diaphragm should remain in place for 6 hours after intercourse and **should be removed as soon as possible thereafter**. Prolonged, continuous wearing of the diaphragm for more than 24 hours is not recommended due to the possibility of bacterial growth in the vagina. It has been suggested that under certain as yet unestablished conditions overgrowth of these bacteria may lead to symptoms of TSS.

Check with your doctor about using a diaphragm while you are menstruating (on your period).

**Warning: Keep this and all drugs out of the reach of children.**

If swallowed, get medical help or contact a Poison Control Center right away.

**Other Information:**

- Studies have raised safety concerns that products containing the spermicide Nonoxonyl-9 can irritate the vagina and rectum. Sometimes this irritation has no symptoms. This irritation may increase the risk of getting HIV/AIDS from an infected partner.
- You can use Nonoxonyl-9 for birth control with or without a diaphragm or condom if you have sex with only one partner who is not infected with HIV and who has no other sexual partners or HIV risk factors.
- Use a latex condom **without** Nonoxonyl-9 if you or your sex partner has HIV/AIDS, multiple sex partners, or other HIV risk factors.
- Ask a health professional if you have questions about your best birth control and STD prevention methods.
- When used correctly every time you have sex, latex condoms greatly reduce, but do not eliminate, the risk of catching or spreading HIV, the virus that causes AIDS.
- If this product is used together with another contraceptive method, there will probably be better protection against pregnancy.

**Adverse Reactions:** If you or your partner develop burning or irritation of the vagina or penis, or experience difficult or painful urination, discontinue use of this product and consult your doctor.

**Tamper-Evident Feature:** The tube opening is covered with a seal. DO NOT USE if seal is punctured or damaged.

**Storage Instructions:** Store at room temperatures, 20°–25°C (68–77°F). Avoid exposure to extremes of hot or cold. See box end flap or crimped end of tube for lot number and expiration date.

**Questions?** If you have any questions, call our toll free line at **1-888-317-4402**. Monday through Friday between 9AM and 5PM EST. Or visit our website at [www.reviveppc.com](http://www.reviveppc.com)

129841  
Rev. 1

**Directions for Use with Diaphragm**

Please read the following directions carefully before use.

1. Wash your hands with soap and water before you use **Options Gynol II® Vaginal Contraceptive Gel** or handle the diaphragm.
2. Unscrew cap and notice its puncture-top. To open the tube, reverse the cap and place the puncture-top against the tube seal. Push down firmly until the seal is broken.
3. Prior to inserting the diaphragm, put a teaspoonful (or an applicatorful) of **Options Gynol II** into the cup of the diaphragm and spread a small amount around the rim with your fingertip. The diaphragm is now ready for insertion according to your doctor's instructions.

**Note:**

To be effective for contraception, **intercourse can occur immediately** and up to 6 hours after the diaphragm and gel have been properly inserted.

**Do not remove your diaphragm for at least 6 hours** following your last act of intercourse.

**An additional application of Options Gynol II must be inserted prior to each act of intercourse** regardless of the time of original insertion. Use the included applicator and follow the directions on the next page. **DO NOT REMOVE THE DIAPHRAGM FOR RE-APPLICATION** and be careful not to dislodge the diaphragm.

**Douching is not recommended** after use of **Options Gynol II** as it can wash away the spermicide before it has finished the job. However, if desired, be sure to wait at least 6 hours following your last act of intercourse.



**Percentage of Women Experiencing Unintended Pregnancy During the First Year of Typical Use<sup>1</sup> in the United States**

Method	%
No Method	85
Sponge	16-32
Spermicides	29
Diaphragm with spermicide	16
Condoms without spermicides <sup>2</sup>	15
Various hormonal methods	.05-8
Sterilization	.15-.50

Adapted from Summary Table of Contraceptive Efficacy found at <http://www.contraceptivetechnology.com/table.html>  
Source: Trussell J. Contraceptive efficacy. In Hatcher RA, Trussell J, Nelson AL, Cates W, Stewart FH, Kowal D. Contraceptive Technology: Nineteenth Revised Edition. New York NY: Ardent Media, 2007.

<sup>1</sup> Includes failures from incorrect or inconsistent use.  
<sup>2</sup> Male condoms. Rate for female condoms is higher.

**EXTRA STRENGTH**

**DIRECTIONS FOR USE**



**Options GYNOL II®**  
VAGINAL CONTRACEPTIVE GEL

**Effective enough to use alone.**

**Options Gynol II®** can be used alone, with a condom or with a diaphragm. It's ready when you are, with no hormonal side effects.

**Important:**

Effectiveness of any contraceptive method is directly related to the accuracy and consistency with which the method is used. Therefore, it is critically important that you follow the directions carefully each time you engage in sexual activity.

Ask a doctor before use if you have been told that you should not become pregnant.

Remember, no product can guarantee against pregnancy.

**Directions for Using the Applicator with Diaphragms (Re-Application), Condoms or When Used Alone**

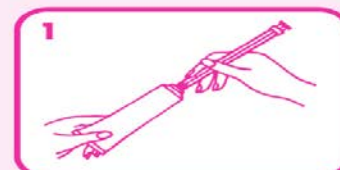

**1.** Remove cap from tube and attach applicator to tube by turning applicator clockwise.



**2.** Squeeze the tube from the bottom, forcing the contents into the applicator. The applicator is full when the plunger is pushed out as far as it will go. Visually check for air pockets. Gently squeeze tube to fill any air pockets with **Gynol II**. Remove applicator from the tube.



**3.** Gently insert the filled applicator into the vagina as far as it will go comfortably. Press the plunger and, while still depressed, remove the applicator. Insertion of the applicator is accomplished more easily when lying on your back with the knees bent.  
\*Optional

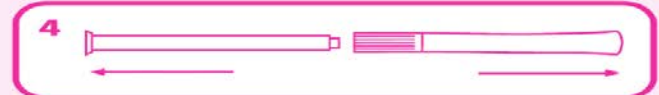

**4. After each use,** separate the applicator parts and wash with mild soap and warm water. Rinse thoroughly. Allow to air dry.